

# OPERATING MANUAL

---

For Ambassador lift & recline chairs

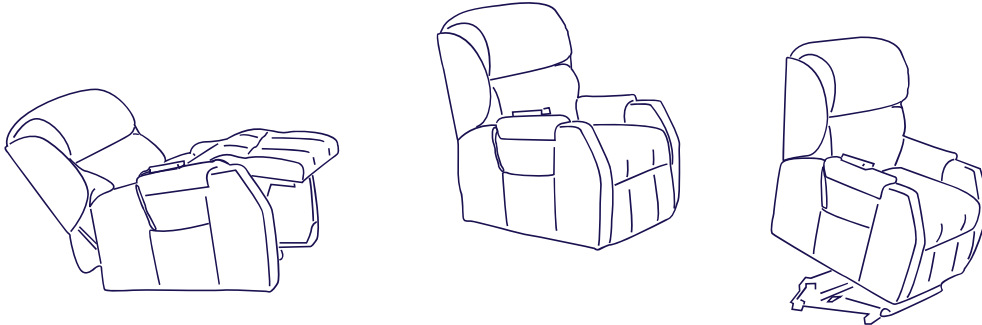

**Note:** Read this Operating Manual carefully before operating your lift & recline chair.

**Using your Ambassador Lift & Recline chair safely depends upon your diligence in following the instructions given in this Operating Manual. The safety use of Ambassador products depends also on your own good judgement and /or common sense.**

**Ambassador is not responsible for injuries and /or damage resulting from any person's failure to follow the instructions given in this Operating Manual. Ambassador is not responsible for injuries and /or damage resulting from any person's failure to exercise good judgement and/or common sense.**

## Safety Guidelines

- **Do not allow liquids to come into contact with the hand control or any electrical components. Do not operate the hand control if wet or damaged.**
- **Do not place chair over power cords.**
- **Ensure the hand control is secured in a side pocket or under the armrest strap (if fitted) when not in use.**
- **Children must not play with the hand control and must be strictly supervised at all times when in the vicinity of the chair.**
- **Do not allow pets near the chair when it is in motion and always ensure the surrounding area is free of obstructions before operating your chair.**
- **Only one person is to use the chair at any one time.**

## Contents

I.	INTRODUCTION	4
II.	CARE AND MAINTENANCE	4
III.	CHAIR SPECIFICATIONS	5
IV.	OPERATING INSTRUCTION (A1 & A4 TYPE)	6
	• RECLINING FUNCTION	7
	• LIFTING FUNCTION	8
V.	OPERATING INSTRUCTION (A2 TYPE)	9
	• RECLINING FUNCTION	10
	• LIFTING FUNCTION	13
VI.	OPERATING INSTRUCTION (A1 & A4 TYPE AND HEAT & MASSAGE)	15
VII.	OPERATING INSTRUCTION (A2 TYPE AND HEAT & MASSAGE)	17
VIII.	HEAT & MASSAGE FUNCTION	19
IX.	WARRANTY	21

## I. Introduction

Congratulations on purchasing Australia's best Ambassador Lift & Recline chair. Your Ambassador chair has been designed and built to provide you with years of comfort and enjoyment. We use only the best materials, tried and tested lifting mechanism, leading brand of electrical system, and skills and experience of our tradespeople to give you trouble-free operation to ensure complete satisfaction.

Your safety is important to us. Please read and apply all of the information in this manual before you attempt to operate your Lift & Recline chair for the first time.

This Operating Manual is compiled from the latest specifications and product information available at the time of printing. We reserve the right to make changes as they become necessary. Any changes therefore, may cause slight variations between the illustrations and explanations in this manual and the product you purchased.

## II. Care and Maintenance

- The chair should be placed near a properly wired standard wall outlet. Allow approximately 80 cm from the backrest and 60 cm in front of the chair to allow sufficient room to recline.
- Do not sit on or push footrest down manually at any time as damage to the chair may result.
- To help reduce wear on the upholstery and retain the look of your chair it is recommended that you:
  - Take care not to spill liquids, foodstuffs or other substances onto the chair that may stain the upholstery.
  - Clean vinyl upholstery regularly by wiping over with a clean cloth and a mild solution of soap and water; or
  - Clean fabric upholstery regularly by vacuuming.
- Under normal circumstances the chair does not require any maintenance. However, due to chair movements in transportation, positioning on uneven flooring, excessive use, etc. it is advisable to periodically check all bolts, nuts, screws and pins for any sign of loosening up.
- If you notice any unusual and suspicious noise or movements, please stop operating the chair immediately to avoid possible damage and inspect the chair for the possible causes. If you unable to do so, please call your place of purchase for assistance.

**If you have any queries regarding safety issues, care or operation of your chair, please contact your Ambassador provider or Ambassador Motion Furniture on Toll Free 1800 807 896.**

### III. Chair Specifications

Range of Ambassador Lift & Recline chairs fitted with A1, A2, A3 or A4 type mechanism.

A1 and A4 type of mechanism means that one function is LIFT movement and another is simultaneous RECLINE (movement) of backrest and footrest.

A2 and A3 type of mechanism means that there are six independent movements of backrest (UP and DOWN), footrest (UP and DOWN) and lift (UP and DOWN).



Premier A1



Premier A2



Premier A3



Premier A4

Specifications	Premier A1	Premier A2	Premier A3	Premier A4
Lifting capacity	140 kg	160 kg	250 kg	120 kg
Seat height	50 cm	52 cm	53 cm	40 cm
Seat depth	48 cm	50 cm	55 cm	45 cm
Seat width	50 cm	50 cm	68 cm	43 cm
Arm height	17 cm	17 cm	20 cm	17 cm
Back height	77 cm	75 cm	78 cm	68 cm
Overall width	80 cm	85 cm	102 cm	70 cm
Overall height	115 cm	115 cm	115 cm	102 cm
Overall length	95 cm	95 cm	100 cm	77 cm
Removable backrest	Yes	Yes	Yes	Yes

Note: All measurements may vary slightly and are subject to change without notice.

**WARNING! Exceeding the weight limit voids your Ambassador warranty and may result in personal injury and/or damage to your Lift & Recline chair.**

## IV. Operating Instruction

### A1 & A4 type of mechanism

The hand control operates all functions of your chair. Refer to the illustration and table below for a brief description the buttons.

Button	What it does
<b>1</b>	From the standing position, lowers the chair to the sitting position. From the sitting position, reclines the chair.
<b>2</b>	From the recline position, raises the backrest and lowers the footrest to the sitting position. From the sitting position, lifts the chair to the standing position.

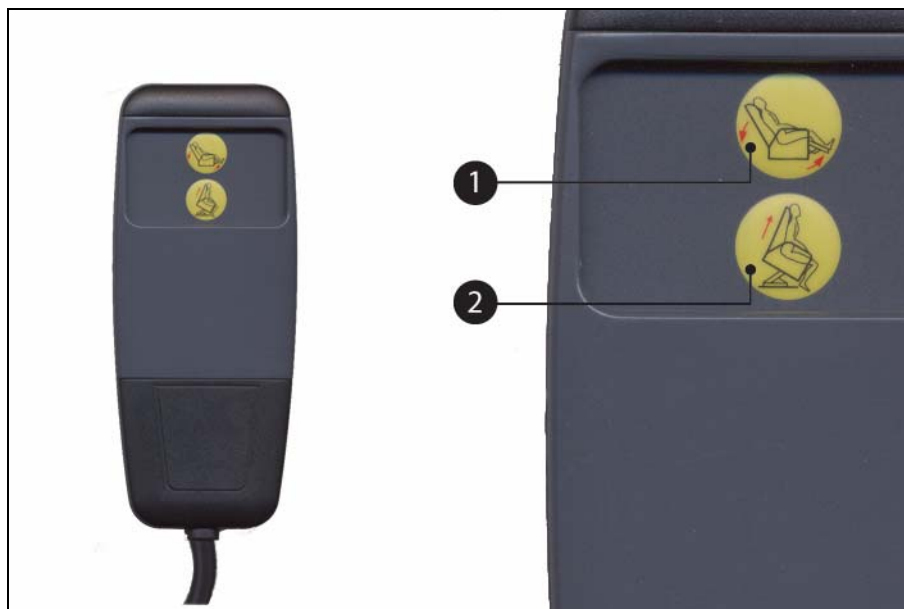

Hand Controller

## Reclining Function



### *To recline the chair*

1. Press and continue to hold down the button numbered **1** on the top row of the control panel.
2. The footrest and backrest will automatically stop when they are fully extended; or take your finger off the button when the desired position is reached.

### *To return the chair to the normal sitting position*

1. Press and continue to hold down the button numbered **2** on the second row of the control panel and.
2. Take your finger off the button when the chair is in the normal sitting position or when the desired position is reached.

**Note:** If you continue to press the button after the sitting position is reached, the chair will begin to lift into the standing position.

## Lifting Function



### ***To lift the chair to the standing position***

1. Press and continue to hold down the button numbered **2** on the hand control.  
If you are in the sitting position, the chair will begin to lift immediately.  
If you are in recline position, the chair will return to the sitting position before it begins to lift.
2. The chair will automatically stop when it is fully upright; or take your finger off the button when the chair is at the stage that you can comfortably get out of it.

### ***To lower the chair to the normal sitting position***

1. Sit right back into the chair.
2. Press and continue to hold down the button numbered **1** of the hand control.
3. When the sitting position is reached, take your finger off the button; or continue to hold down the button to recline.

## V. Operating Instruction

### A2 type of mechanism

The hand control operates all functions of your chair. Refer to the illustration and table below for a brief description of the buttons.

Button	What it does
<b>1</b>	Lowers the backrest.
<b>2</b>	Raises the backrest.
<b>3</b>	From the standing position, lowers the chair to the sitting position; and/or raises the footrest.
<b>4</b>	Lowers the footrest; and/or from the sitting position, lifts the chair to the standing position with the backrest in either the up or down position.
<b>5</b>	From the standing position, lowers the chair to the sitting position; and/or raises the footrest.
<b>6</b>	Simultaneously raises the backrest and lowers the footrest; and/or from the sitting position, lifts the chair to the standing position.

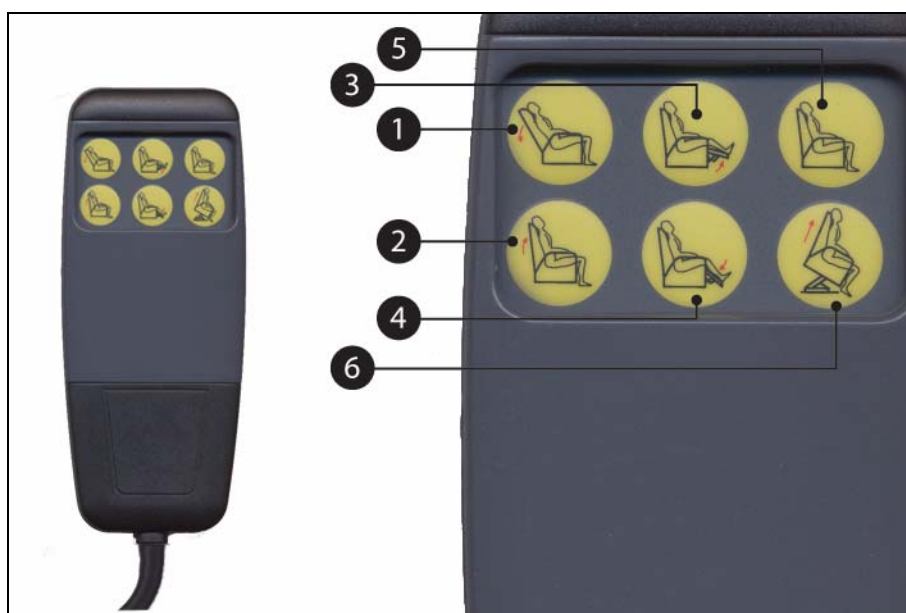

Hand Controller

## Reclining Function

The backrest and footrest work independently of each other except that they can be contracted simultaneously into the upright position.



### *To lower the backrest*

1. Press and continue to hold down the button numbered **1** on the control panel.
2. The backrest will automatically stop when it is fully lowered; or take your finger off the button when the desired position is reached.



**To raise the backrest**

1. Press and continue to hold down the button number ② on the control panel.
2. The backrest will automatically stop when it is fully upright; or take your finger off the button when the desired position is reached.

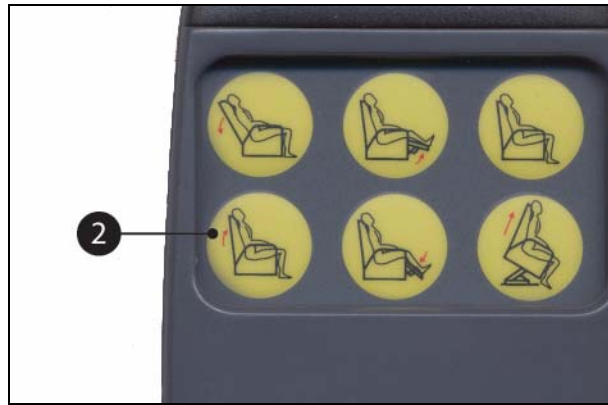
**To raise the footrest**

1. Press and continue to hold down the button number ③ on the control panel.
2. The footrest will automatically stop when it is fully extended; or take your finger off the button when the desired position is reached.

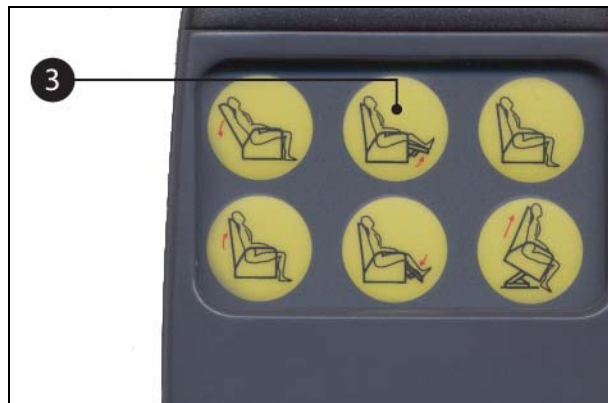

### ***To lower the footrest***

1. Press and continue to hold down the button numbered **4** on the control panel.
2. Take your finger off the button when the footrest is secured under your chair or when the desired position is reached.

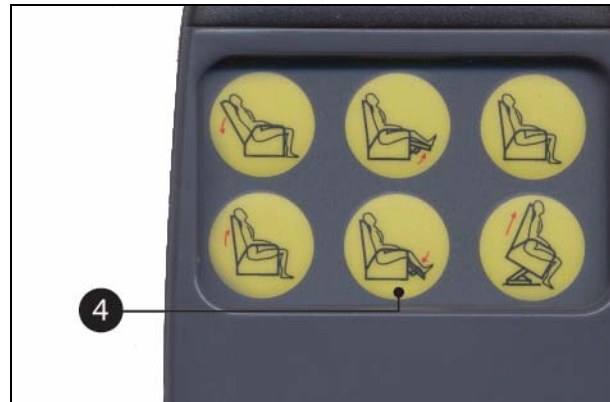

**Note:** If you continue to press the button after the footrest is lowered, the chair will begin to lift into the standing position.

### ***To raise the backrest and lower the footrest simultaneously***

3. Press and continue to hold down the button number **6** on the control panel.
4. Take your finger off the button when the chair is in the normal sitting position or when the desired position is reached.

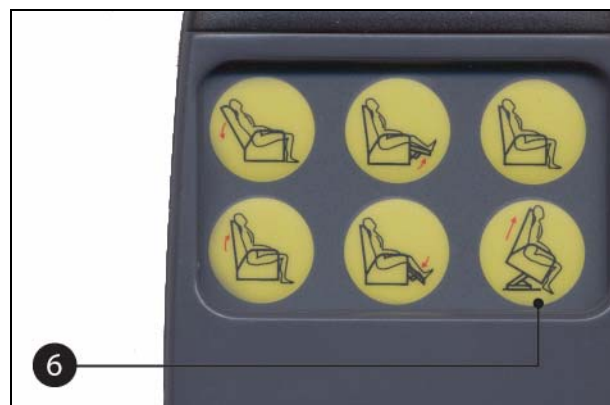

**Note:** If you continue to press the button after the sitting position is reached, the chair will begin to lift into the standing position.

## Lifting Function

Under normal conditions, the backrest will automatically rise to the upright position before the chair lifts into the standing position. Whilst this is the preferred method, the chair can also lift into the standing position whilst the backrest remains lowered, however this is recommended only when certain medical conditions exist.



### ***To lift the chair to the standing position with the backrest up***

1. Press button number **6** on the hand control.
2. If the backrest is lowered and/or the footrest is raised, they will contract before the chair begins to lift.
3. The chair will automatically stop when it is fully upright; or take your finger off the button when the chair is at the stage that you can comfortably get out of it.

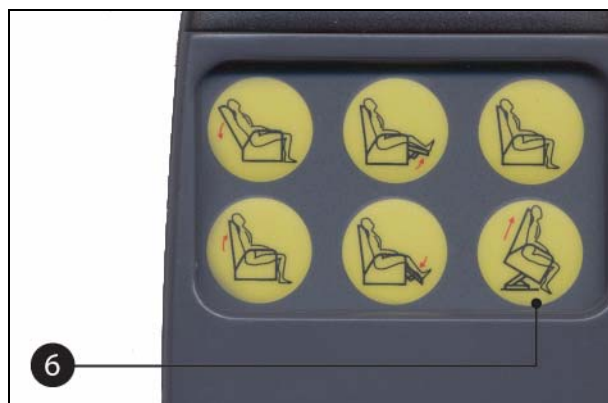

***To lift the chair to the standing position with the backrest down***

1. Press and continue to hold down the button numbered **4** on the top row of the hand control. The footrest will lower to the normal sitting position before the chair lifts.
2. If the footrest is raised, it will lower before the chair begins to lift.
3. The chair will automatically stop when it is fully upright; or take your finger off the button when the chair is at the stage that you can comfortably get out of it.

***To lower the chair to the normal sitting position***

4. Sit right back into the chair.
5. Press and continue to hold down the button number **3** on the hand control, **or** button number **5** of the hand control.



**Note:** If you continue to press the button after the sitting position is reached, the footrest will rise.

## VI. Operating Instruction

### A1 & A4 type of mechanism and Heat & Massage System

The hand control (see illustration next page) operates all functions of your chair. The table below provides a brief description of each of the hand control buttons and lamps.

BUTTON	WHAT IT DOES
<b>Yellow buttons – the recline and lift buttons</b>	
Backrest/Footrest (upper row) ❶	Raises the backrest and lowers the footrest to the sitting position; and/or From the sitting position, lifts the chair to the standing position.
Backrest/Footrest (lower row) ❷	From the standing position, lowers the chair to the sitting position; and/or From the sitting position, reclines the chair.
<b>Blue buttons – the massage buttons</b>	
Lumbar +	This option is not available.
Support –	This option is not available.
Vibration Intensity	Varies the speed of the vibrations to increase or decrease the massage intensity. There are three levels of massage.
Vibration Rhythm	Changes the rhythm of massage.
Wave / Tapping / Flat	Varies the style of the massage. There are three massage styles: <ul style="list-style-type: none"> <li>• Wave - each of the selected vibrators momentarily starts and stops in sequence, giving a “thumping” sensation.</li> <li>• Tapping – all selected vibrators cycle through high, medium and low intensity levels.</li> <li>• Flat – the “normal” or continuous vibration.</li> </ul>
Stop	Turns the massage and/or heat functions off.
Zone On	With each press of the button, cycles through the three combinations of vibrators (see the illustration on page 7): <ul style="list-style-type: none"> <li>• combination one - vibrators V1 and V2</li> <li>• combination two - vibrators V3 V4 &amp; V5</li> <li>• combination three - vibrators V1, V2, V3, V4 &amp; V5 .</li> </ul>
Single On	With each press of the button, cycles through each of the motors individually button, starting with V1.
<b>Red button – the thermo (heat) button</b>	
Thermo	Turns the heat function on and off.
<b>LAMP</b>	
V1 to V5	When illuminated, indicates the vibrators in use.
+	Illuminates momentarily when the massage intensity is increased.
-	Illuminates momentarily when the massage intensity is decreased.
Thermo	Illuminates when the thermo, or heat, function is in use.

## Hand Control for A1 & A4 Type of Mechanism and Heat & Massage System



## VII. Operating Instruction

### A2 type of mechanism and Heat & Massage System

The hand control operates all functions of your chair. Refer to the illustration and table below for a brief description of the buttons.

<b>BUTTON</b>	<b>WHAT IT DOES</b>
<b>Yellow buttons – the recline and chair lift buttons</b>	
Backrest up	Raises the backrest.
Backrest down	Lowers the backrest.
Footrest up	From the normal sitting rises the footrest. From the standing position, lowers the chair to the normal sitting position.
Footrest down	From the normal sitting position, rises the chair to the standing position. When the footrest is raised, lowers it.
Backrest/Footrest (upper row)	From the normal sitting position, lifts the chair to the standing position. When the footrest is raised and the backrest lowered, simultaneously contracts both to the normal sitting position.
Backrest/Footrest (lower row)	From the normal sitting position, raises the footrest and lowers the backrest simultaneously. From the standing position, lowers the chair to the normal sitting position.
<b>Blue buttons – the massage buttons</b>	
Lumbar +	This option is not available.
Support –	This option is not available.
Vibration Intensity	Varies the speed of the vibrations to increase or decrease the massage intensity. There are three levels of massage.
Vibration Rhythm	Changes the rhythm of massage.
Wave / Tapping / Flat	Varies the style of the massage. There are three massage styles: <ul style="list-style-type: none"> <li>• Wave - each of the selected vibrators momentarily starts and stops in sequence, giving a “thumping” sensation.</li> <li>• Tapping – all selected vibrators cycle through high, medium and low intensity levels.</li> <li>• Flat – the “normal” or continuous vibration.</li> </ul>
Stop	Turns the massage and/or heat functions off.
Zone On	With each press of the button, cycles through the three combinations of vibrators (see the illustration on page 7): <ul style="list-style-type: none"> <li>• combination one - vibrators V1 and V2</li> <li>• combination two - vibrators V3, V4 &amp; V5</li> <li>• combination three - vibrators V1, V2, V3, V4 &amp; V5 .</li> </ul>
Single On	With each press of the button, cycles through each of the motors individually button, starting with V1.

Red button – the thermo (heat) button	
Thermo	Turns the heat function on and off.
<b>LAMP</b>	<b>WHAT IT DOES</b>
V1 to V5	When illuminated, indicates the vibrators in use.
+	Illuminates momentarily when the massage intensity is increased.
-	Illuminates momentarily when the massage intensity is decreased.
Thermo	Illuminates when the thermo, or heat, function is in use.

### Hand Control for A2 Type of Mechanism and Heat & Massage System



## VIII. Heat & Massage Function

### Heating Function

The thermo function heats the lower backrest at a comfortable temperature for approximately 15 to 20 minutes at a time. As with the massage function, the thermo automatically shuts down after this time to avoid overheating. You can restart thermo function after approximately 10 minutes or when it is sufficiently cooled. The temperature of the thermo function is fixed and cannot be changed. You can use the thermo control and the vibration function simultaneously.

#### ***Turning the Thermo On***

1. Press the red ***Thermo*** button. The Thermo lamp will illuminate and the backrest slowly increases in temperature.

#### ***Turning the Thermo Off***

1. Press the red ***Thermo*** button. The Thermo lamp will go out and the backrest slowly decrease in temperature.

### Massage Function

Five small motors inside the lower backrest of your chair provide the vibrations to massage your back. The following diagram shows the approximate location and names of the vibrators.

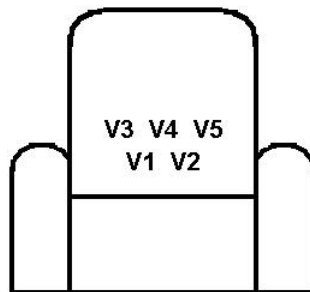

You can use the massage function for approximately 15 to 20 minutes at a time. As with the thermo function, it will automatically shut down after this time to avoid overheating. The massage can be restarted after approximately 10 minutes or when the vibrators are sufficiently cooled.

The vibrators can be run individually to massage a particular spot, or be combined to massage the upper, lower or all areas of your back and you can select the intensity level and style of the vibrations. You can also use the massage and thermo function simultaneously.

#### ***To massage a specific spot of your back***

1. Press the blue ***Single On*** button. Vibrator V1 will start to massage at the lowest massage intensity and in flat vibration style.
2. Press the ***Single On*** button again until the required spot is reached. Each press stops the current vibrator and activates the next one in an anticlockwise direction.

### ***To massage more than one spot of your back***

1. Press the blue ***Zone On*** button. The V1 and V2 vibrators will start to massage at the lowest massage intensity in the flat vibration style.
2. If you wish to massage the upper zone of your back, press the ***Zone On*** button again. The V1 and V2 vibrators will stop and the V3, V4 and V5 vibrators begin.
3. If you wish to massage all areas of your back, press the ***Zone On*** button a third time to activate all the vibrators.

### ***To turn the massage off***

Press the red ***Stop*** button.

**Note:** Pressing the ***Stop*** button will also shut off the thermo function if it is on.

## Changing the Intensity of the Massage

There are three vibrator speeds to determine the intensity of your massage. When you start the massage feature by pressing the ***Single On*** or ***Zone On*** button, the vibrators run at their lowest speed, giving you the lowest intensity massage.

### ***To increase the intensity***

1. Press the blue ***Vibration Intensity*** button. The + lamp on the bottom of the control panel will momentarily illuminate and the intensity of the massage increase to the medium level.
2. Press the ***Vibration Intensity*** button again to operate the massage at its highest level.

### ***To decrease the intensity***

The massage intensity level will only decrease after the highest intensity level is reached (ie. after the ***Vibration Intensity*** button has been pressed twice).

1. Press the ***Vibration Intensity*** button. The – lamp on the bottom of the control panel will momentarily illuminate and the intensity of the massage decrease to the medium level.
2. Press the ***Vibration Intensity*** button again to operate the massage at its lowest level.

## Changing the style of the massage

When you turn on the massage feature by pressing the ***Single On*** or ***Zone On*** buttons, the massage is operating in the flat (or normal) style.

1. Press the blue ***Wave/Tapping/Flat*** button to activate the “Wave” message style.
2. Press the button again to activate the “Tapping” style.
3. Press the button a third time to return to the “Flat” or normal message style.

**Note:** The Tapping style is most noticeable when only one vibrator is running.

## IX. Warranty

1. Ambassador offers twelve (12) months warranty on all components of the chair with the exclusion of the upholstery cover.
2. Within the period of twelve (12) months from the date of purchase by the original owner and upon presentation of the proof of purchase, Ambassador will, at its discretion, repair or replace, free of charge, any of the following parts found upon examination by an authorised representative of Ambassador to be defective in material and/or workmanship:
  - i. Timber frame;
  - ii. Lifting mechanism;
  - iii. Electrical components.
3. This warranty is valid on condition that:
  - i. Upon prior arrangement, the complete chair is returned to Ambassador or one of its Authorised Agents, freight pre-paid both ways, and found upon examination, to be suffering from material or constructional defect;
  - ii. The chair or relevant part has not been subjected to misuse, neglect, or been involved in an accident;
  - iii. The repairs are not required as a result of normal wear and tear;
  - iv. The chair is clean and free from stains, human or animal hair, or any other materials that may present danger of infection or disease.
4. Ambassador is not liable under this warranty for the following:
  - i. Damage resulting from abuse, misuse, unauthorised repairs, negligence, accident(s), alterations, or modifications of the product;
  - ii. Damage caused by common carrier's abuse or mishandling;
  - iii. Any special, indirect, incidental, and/or consequential damages.
5. After the warranty period, Ambassador shall have no obligations under any warranties, expressed or implied (including implied warranties of merchantability and fitness for a particular purpose).



**Ambassador Motion Furniture**  
Unit 3, 17 Stennett Rd  
INGLEBURN NSW 2565  
Tel: 02-9829 2344  
Fax: 02-9829 4833  
e-mail: [sales@ambassadorproducts.com.au](mailto:sales@ambassadorproducts.com.au)  
[www.ambassadorproducts.com.au](http://www.ambassadorproducts.com.au)  
POLWES Pty Ltd      ABN 14 092 456 927